

Cooperation and way forward to ensure sustainable vegetable oils

alain.rival@cirad.fr

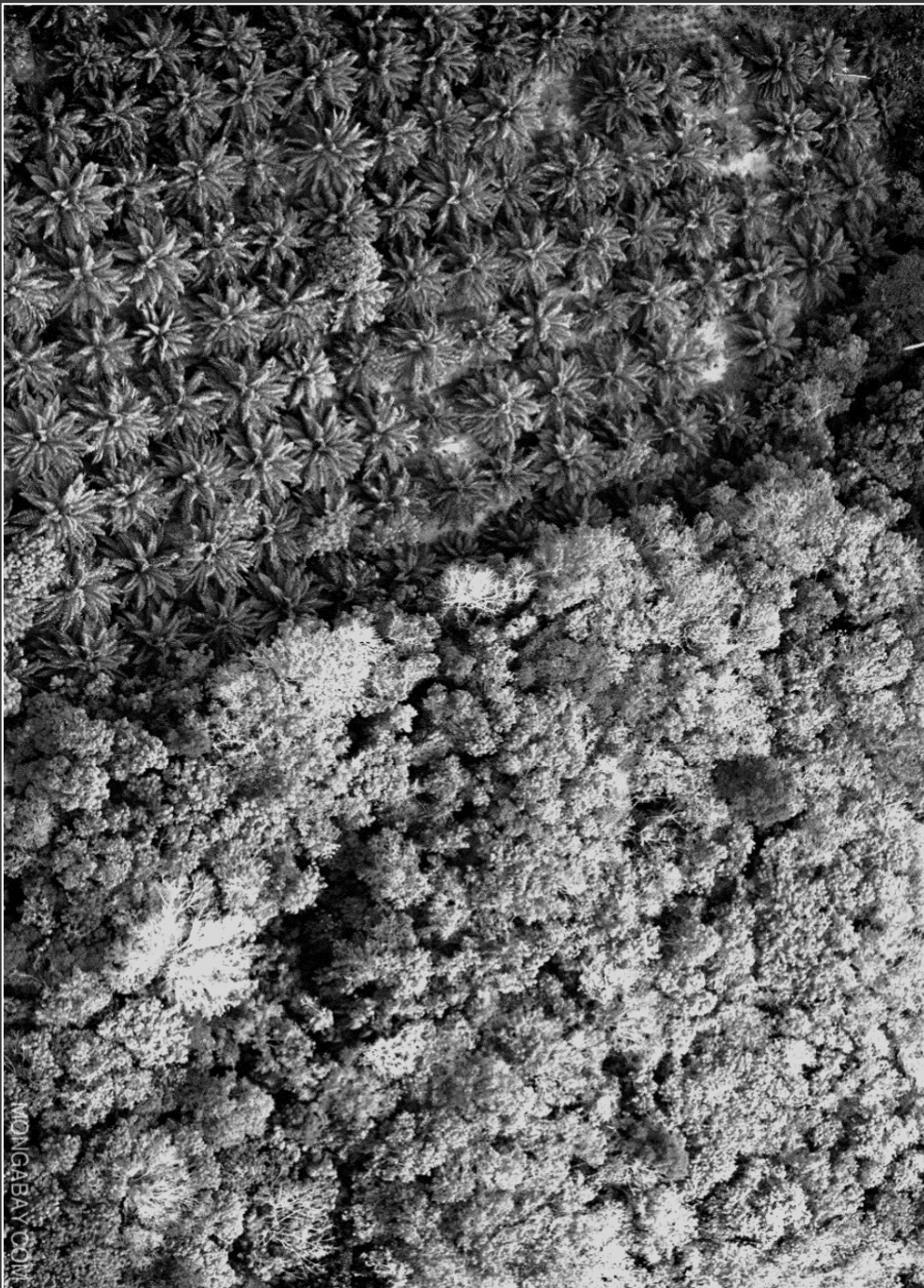



- **Intensive monoculture** has been the norm for most of plantation crops
- This system relies on **abundant arable land and docile work force.**
- The 2015 El Nino episode demonstrated the **poor climatic resilience** of intensive monocrop systems.
- The CoVid pandemics has revealed **several weaknesses** (need for mechanization, labor shortages).
- Diversified systems are more able to resist to **price volatility** (more **stable income** from multiple activities).





- TRAILS project builds on a complementary partnership.
- TRAILS links academics, NGO, private and public stakeholders.
- TRAILS relies on long term expertise and multidisciplinary approaches from various science fields.
- TRAILS deals with agronomy, forestry and conservation sciences.



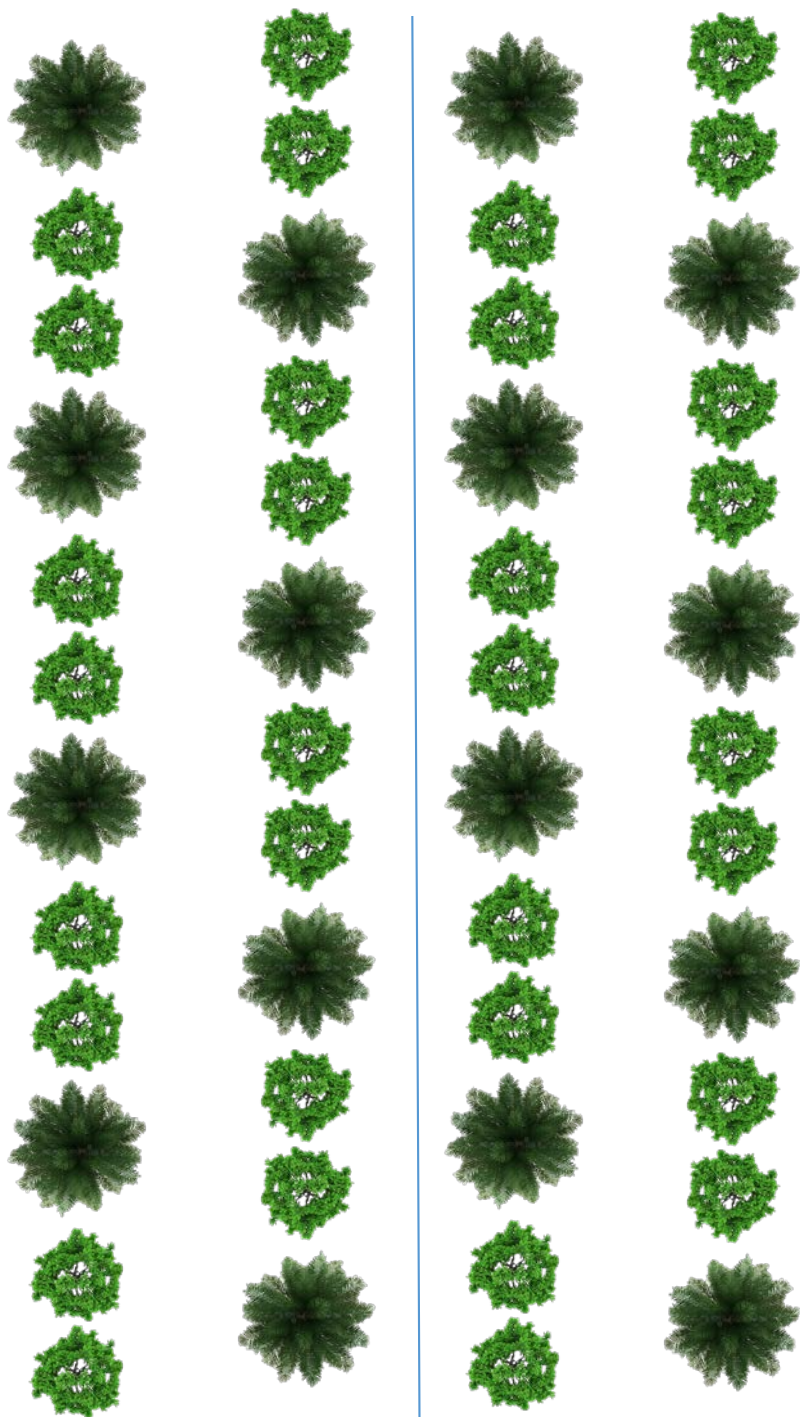

TRIAL 1 : MIXED PLANTATION (TREES & PALMS)

TREATMENT 4

2 forest tree are planted
between 2 palms on the line (128 Trees)
trees & palms spacing is 3m

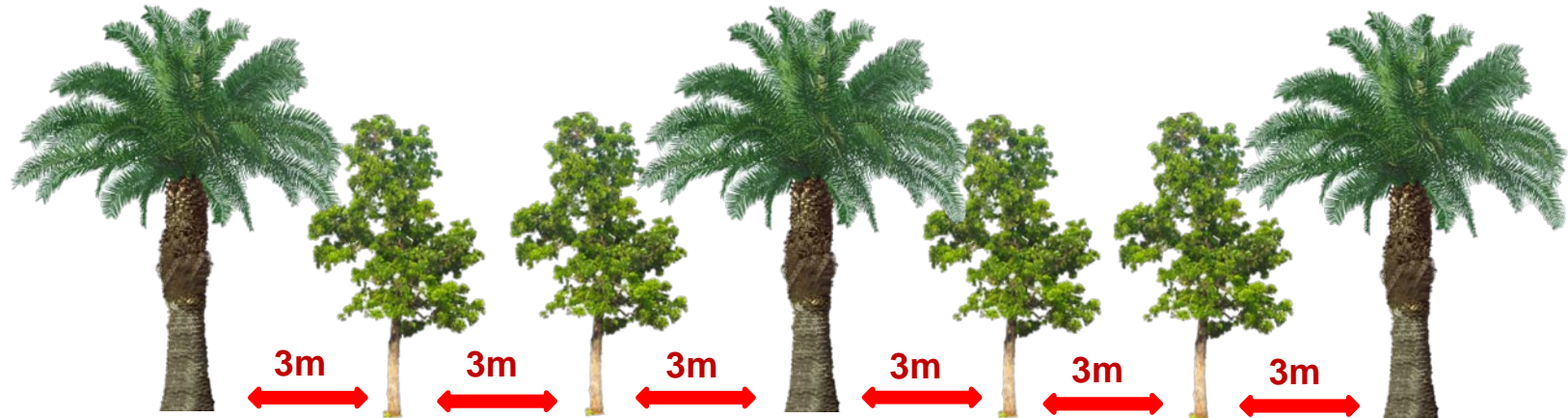



Bring on your TALENT!

TALENT is a training
program for sustainable
plantation landscapes in
Southeast Asia

<https://www.talent-programme.org/>



susTainable LandscapE managemNT



A program designed by Cirad, France

**TALENT program builds on Cirad
worldwide expertise in
sustainable agriculture.**

**Cirad is the French international
cooperation center in agricultural
research for development.**

www.cirad.fr



A program supported by AFD, France

TALENT will benefit from a 1.2 million euros fund from Agence Française de Développement, based in Paris, France.

AFD Group implements France's policy in the areas of development and international solidarity.

It finances, supports and accelerates transitions towards a more coherent and resilient world.

www.afd.fr

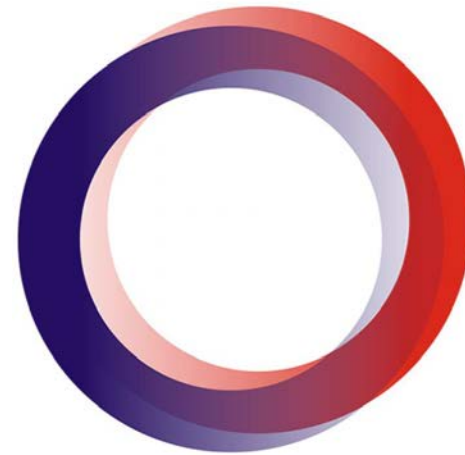

AFD
AGENCE FRANÇAISE
DE DÉVELOPPEMENT

- Addressing sustainability of commodity chains requires cooperation
- The public, the funders, the civil society want clear and immediate answers to complex questions
 - Defining sustainability?
 - Certifying sustainability?
 - Installing credibility
- Cooperation is essential
 - between stakeholders: Governments, NGOs, Research, Industry
 - between countries: CPOPC